

Spiider®



ROBE®

Spüider®

**SUPERBRIGHT
LED
WASHBEAM**

**RGBW
COLOUR
MIXING**

**EASY
CLEAN™
LENS SANDWICH
SYSTEM**

**LIGHT OUTPUT
13.700 lm
50.100 lx @ 5 m**

**INDIVIDUAL
PIXEL
CONTROL**

**ZOOM
4° – 50°**





The Robe Spider® – Our super bright LED WashBeam luminaire has truly set the benchmark in performance! Using 18 x 40 Watt and 1 x 60 Watt LEDs, combined with a highly efficient 12,5:1 zoom optical system, ranging from tight 4° Beam to wide 50° Wash, makes the Spider® the leader in its class. Beautiful convergence of hard edge in-air effects, punchy beams and smooth, homogenized rich colour washes are all encapsulated in the unique Spider®!

The Spider® product family truly sets itself apart. With the eye-catching Robe patented MCFE™ – Multi-Coloured Flower Effects – emitting sharp, multi-coloured spikes of light, including variable speed and rotation direction control to further increase the projection of charismatic in-air animations.

Dynamic video effects are easily achieved by mapping individual pixels and controlled by DMX desk or media servers via sACN with internal HTP merging, DMX or by Kling-Net protocol. Equipped with Robe's innovative lens coating technology, the lenses keep bright and clear, with no scratches or marks, providing higher light output for longer intervals between cleaning

Perfect colour and dimming control are available via RGBW and CMY colour mixing modes; our 18 Bit L3™ Low Light Linearity dimming software for imperceptible fades to black; variable CCT of 2.700K – 8.000K; tungsten emulation simulating the red shift and thermal delay of tungsten lamps for whites from 2.700K – 4.200K; and our DataSwatch™ 237 pre-programmed colour library

Source

- Light Source Type: 1 x 60W RGBW and 18 x 40W RGBW LED multichips
- LED Life Expectancy: min. 50.000 hours
- Typical Lumen Maintenance: L70/B50 @ 50.000 hours

Optical System

- Robe's proprietary optical design
- High-efficiency zoom optical system, ratio 12.5:1
- Zoom range: 4°–50°
- Fixture total lumen output: 13.700 lm (integrating sphere) 11.000 lm (goniophotometer)
- Illuminance: 50.100 lx @ 5 m
- RLCT™ Innovative lens coating technology (Patent pending)
- EasyClean™ - newly designed and patented lens sandwich system for easy cleaning and time saving maintenance of the lenses

Dynamic Effects and Features

- Colour mixing mode: RGBW or CMY
- Individual control of each RGBW pixel
- Variable CTO 2.700K–8.000K
- Virtual Colour Wheel with 66 preset swatches
- Tungsten lamp effect: 750W, 1.000W, 1.200W, 2.000W, 2.500W lamp emulation for whites from 2.700K to 4.200K (red shift and thermal delay)
- Colour rainbow effect with variable speed
- Pre-programmed pixel effects with colour, dimming and strobe chases, waves and pulses at variable speed and direction
- MCFE™- (Multi-Coloured Flower Effects) - creating spectacular multicolour beam effects in the air rotating in both directions at variable speed (Patented)
- Strobe effect: variable speed (max.20 flashes per second)
- Pre-programmed random strobe & pulse effects
- High resolution electronic dimming: 0–100 %
- L3™ - (Low Light Linearity) Imperceptible 18 bit dimming for ultra smooth fade to black

Control and Programming

- Setting & Addressing: Robe Navigation System 2 (RNS2)
- Display: QVGA Robe touch screen with battery backup, gravitation sensor for auto screen positioning, operation memory service log with RTC, stand-alone operation with 3 editable programs (each up to 100 steps), built-in analyser for easy fault finding
- Protocols: USITT DMX-512, RDM, Art-Net, MA Net, MA Net2, sACN, Kling-Net
- Wireless CRMX™ technology from Lumen Radio - on request
- DMX protocol modes: 10
- Control Channels: 49, 27, 33, 90, 27, 47, 91, 110, 104, 123
- Pan/Tilt resolution: 16 bit
- R,G,B,W colour mixing (internal 18 bit): 8 or 16 bit
- Zoom: 8 bit
- Dimmer (internal 18 bit): 8 or 16 bit

Movement

- Pan movement: 540°
- Tilt movement: 220°
- Movement control: Standard and Speed
- Controllable speed of Pan & Tilt movement
- EMS™- Electronic Motion Stabilizer system for Pan & Tilt reducing beam deviation caused by truss movement or vibration (Patent pending)
- Automatic Pan & Tilt position correction

Thermal Specification

- Maximum ambient temperature: 45 °C (113 °F)
- Maximum surface temperature: 75 °C (167 °F)
- Minimum operating temperature: -5 °C (23 °F)
- Total heat dissipation: max. 1688 BTU/h (calculated)

Electrical Specification and Connections

- Power supply: Electronic auto-ranging
- Input voltage range: 100–240 V AC, 50-60 Hz
- Power consumption: max. 660 W
- Power connector in: Neutric powerCON TRUE 1
- DMX and RDM data in/out: Locking 3-pin & 5-pin XLR
- Ethernet port in/out: RJ45
- Embedded Ethernet switch 10/100 Mbps: 1 x in / 1 x out
- USB connector (series A)

Approvals

- CE Compliant
- cETLus Compliant (pending)

Environmental Information

- EPD registration number: EPD-IES-0011289:002 (S-P-11289)
- GWP (Global Warming Potential) total in modules A1-A3 (according LCA): 308 Kg CO2e

Mechanical specification

- Height: 477 mm (18.7") – head in vertical position
- Width: 390 mm (15.3")
- Depth: 252 mm (9.9")
- Weight: 13.3 kg (29.2 lbs)
- Ingress protection rating: IP20

Rigging

- Mounting positions: Horizontally or vertically
- Universal operating position
- Mounting points: 2 pairs of 1/4-turn locking points
- 2x Omega adaptors with 1/4-turn quick locks
- Safety cable attachment point
- Tilt transport lock

Included Items

- User Manual
- Omega Adaptor CL-regular 2 pcs
- Power cord including powerCON TRUE1 In connector

Optional Accessories

- Diffusion filter: 2° 10980416
- Clear lens cover: 10980607
- EggCrate: 10980317
- Doughty Trigger Clamp: 17030386
- Safety wire 36 kg: 99011963
- Mounting adapter for one omega holder - black: 10980100
- Mounting adapter for one omega holder - white: 10980129
- Mounting adapter for one omega holder - neutral: 10980113
- Single Top Loader Case: 10120195-01
- Dual Top Loader Case: 10120207
- Quad Top Loader Case: 10120208
- Foam Shell: 2002 0290

Legal

- Spider® is Registered Trademark of Robe lighting s.r.o.
- Spider® is patented by Robe lighting s.r.o. and protected by one or more pending or issued patents



Proprietary Optical System

Robe RnD have designed a new very efficient 12.5: 1 zoom optical system with a range from 4°–50°, resulting in light output of over 13.700 lumens and intensity of 50.000 lux @ 5 m (Patent pending).



Innovative Flower Effect

The innovative MCFE™ - Multi-Coloured Flower Effect creates sharp colourful spikes of light, rotating in both directions at variable speed, adding new visual effect to the show! (Patented)

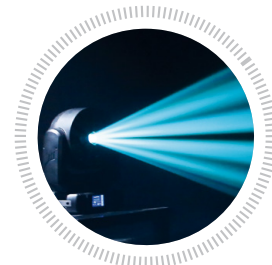

Lens Coating Technology

The innovative lens coating technology protects soft plastic lenses against „surface scattering” even when scrubbed repeatedly. Anti-static properties prolong the time period before the lenses will collect dust and create white maps on the lens surface. The new coating brings countless benefits including longer intervals between cleaning, bright and clear lenses, no scratches or marks, and higher light output (Patent pending).



Pixel Control

Individual pixel control of each LED via DMX or Kling-Net protocols allows to turn the fixture to the low res screen or to create variety of spectacular beam effects in the air.

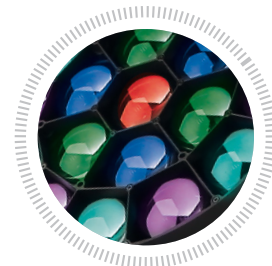

True White Colours

Spotless colormixing of specially calibrated LEDs together with predefined values on a Virtual Colour wheel channel allow quick direct calling of exact white hues of 2.700K, 3.200K, 4.200K, 5.600K and 8.000K.



8.000 K



5.600 K



4.200 K



3.200 K



2.700 K

Tungsten effect

The halogen lamp mode provides emulation of 750W, 1.000W, 1.200W, 2.000W and 2.500W. The dimmer channel initiates halogen lamp-like behavior (red effect and thermal delay) for each lamp type during dimming.



Dimmer 100 %



Dimmer 80 %



Dimmer 50 %



Dimmer 20 %

Max. Zoom



Min. Zoom

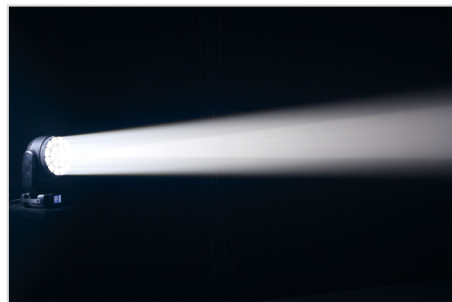

Flower Effect

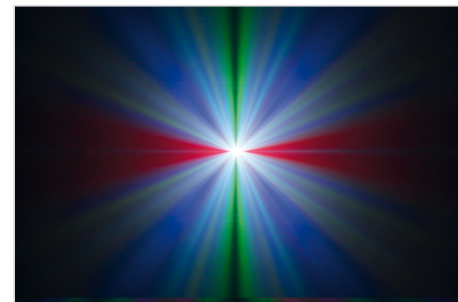

Spider®

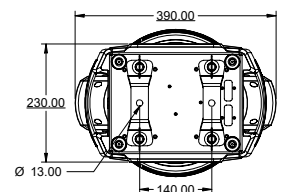
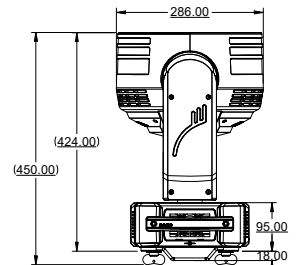
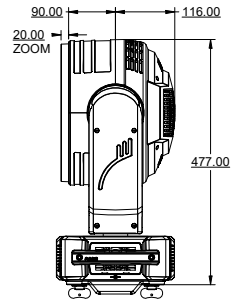
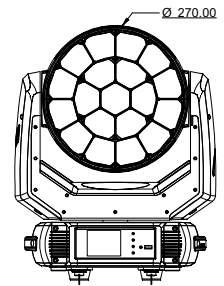

Spiider

Photometric report

Beam angle 5.6° - Min. Zoom

Beam angle	Total lumen output (integrating sphere)	Total lumen output (goniophotometer)	Peak candela	Power
5.6°	6050 lm	5500 lm	1252500 cd	430 W

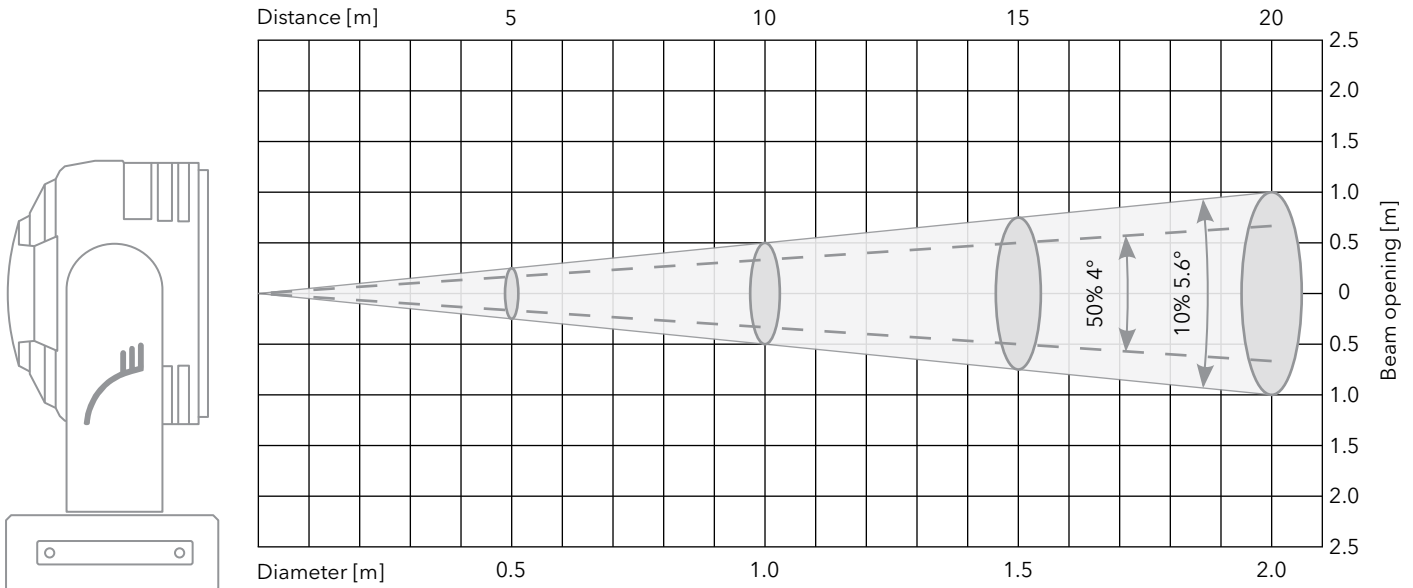

Center beam intensity [lx]/[fcd]; Total lumen output [lm] measured by goniophotometer

Distance	5 m	10 m	15 m	20 m	25 m	30 m	35 m	Total lumens
R+G+B+W	50100/4654	12525/1164	5567/517	3131/291	2004/186	1392/129	1022/95	5500
Red	9320/866	2330/216	1036/96	583/54	373/35	259/24	190/18	1023
Green	16320/1516	4080/379	1813/168	1020/95	653/61	453/42	333/31	1792
Blue	3150/293	788/73	350/33	197/18	126/12	88/8	64/6	346
White	22420/2083	5605/521	2491/231	1401/130	897/83	623/58	458/43	2461

Spectrum

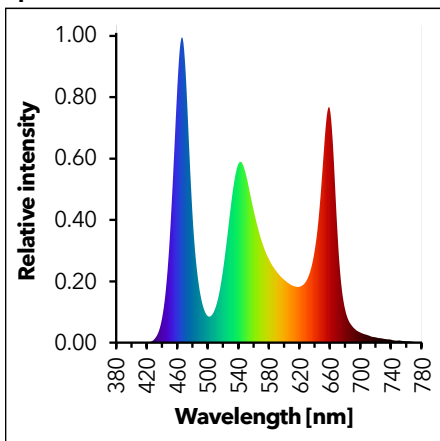

TM-30

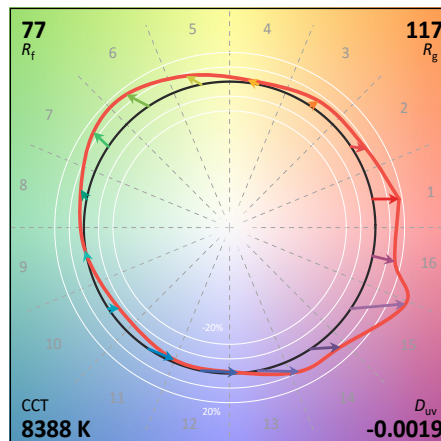

Light distribution

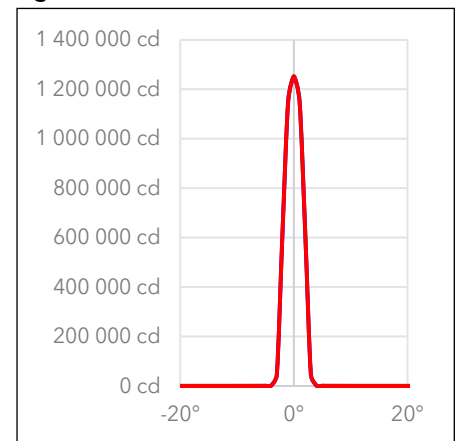

Color temperature	CCT	8388
Color Deviation from Black	Duv	-0.0019
Color Coordinate CIE 1931	x	0.2926
	y	0.2984
Color Coordinate	u	0.1952
	v	0.2986

Color rendering index	CRI	71
Red component	CRI R9	-40
Color fidelity	TM30 Rf	77
Color gamut	TM30 Rg	117
Television consistency Index	TLCI	60

Fixture settings: DMX mode: 1; Flower effect Off; White Point 8000K On; All pixels On
Measurement date: 09.06.2020

Spider

Photometric report

Beam angle 50° - Max. Zoom

Beam angle	Total lumen output (integrating sphere)	Total lumen output (goniophotometer)	Peak candela	Power
50°	13750 lm	11000 lm	31250 cd	430 W

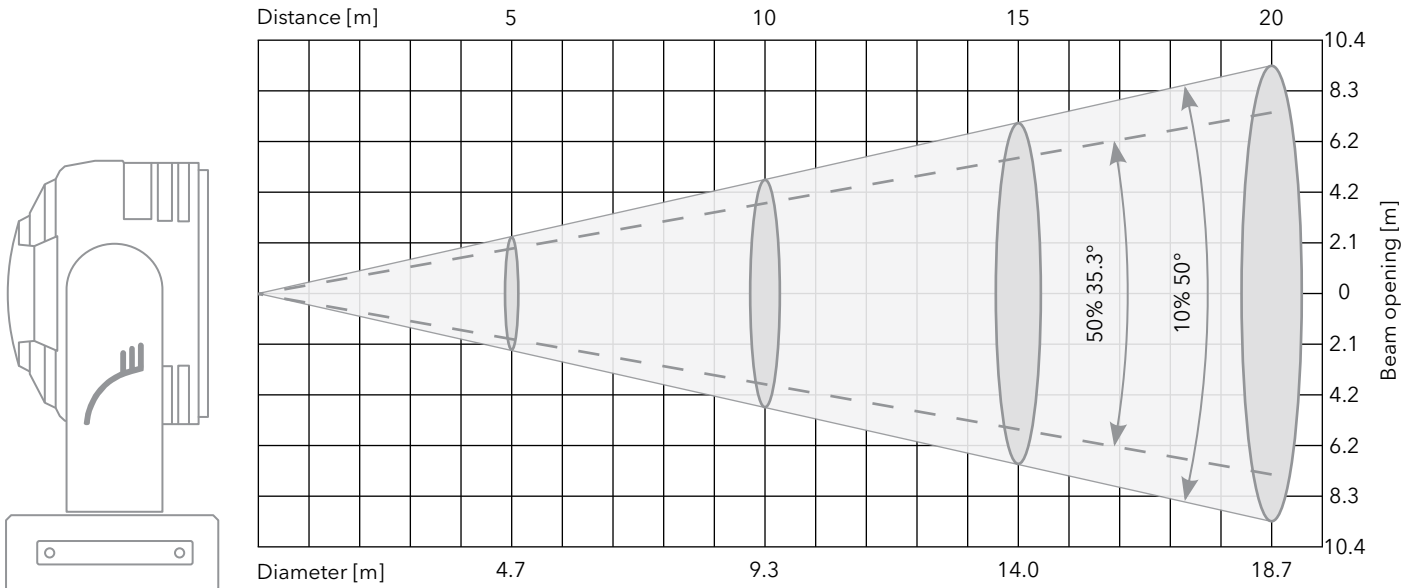

Center beam intensity [lx]/[fcd]; Total lumen output [lm] measured by goniophotometer

Distance	5 m	10 m	15 m	20 m	25 m	30 m	35 m	Total lumens
R+G+B+W	1250/116	313/29	139/13	78/7	50/4.6	35/3.2	26/2.4	11000
Red	235/22	59/5	26/2.4	15/1.4	9/0.9	7/0.6	4.8/0.4	2068
Green	420/39	105/10	47/4.3	26/2.4	17/1.6	12/1.1	9/0.8	3696
Blue	85/8	21/2	9/0.9	5/0.5	3.4/0.3	2.4/0.2	1.7/0.2	748
White	570/53	143/13	63/6	36/3.3	23/2.1	16/1.5	12/1.1	5016

Spectrum

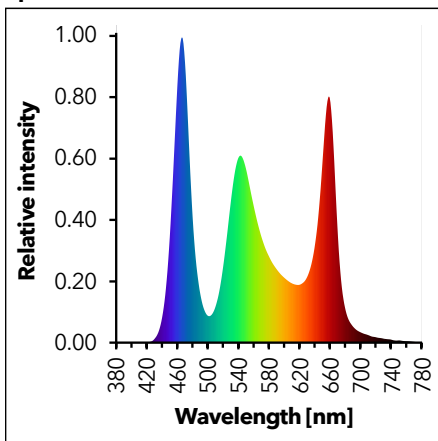

TM-30

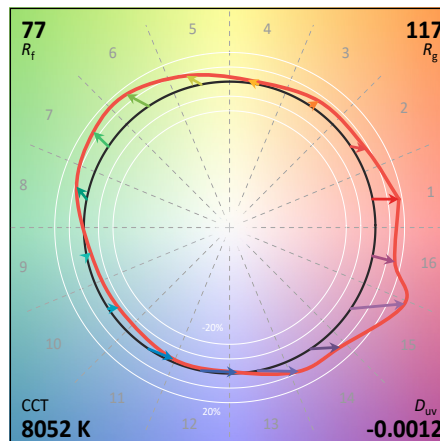

Light distribution

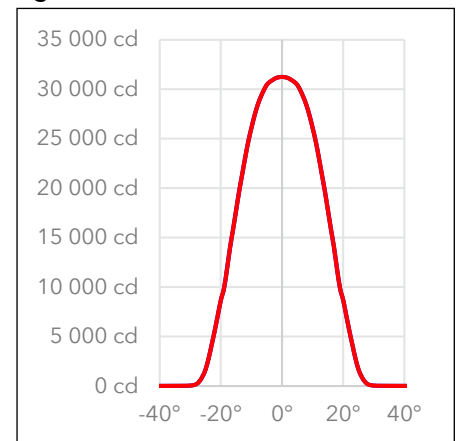

Color temperature	CCT	8052
Color Deviation from Black	D_{uv}	-0.0012
Color Coordinate CIE 1931	x	0.2952
	y	0.3026
Color Coordinate	u	0.1955
	v	0.3006

Color rendering index	CRI	71
Red component	CRI R9	-38
Color fidelity	TM30 R_f	77
Color gamut	TM30 R_g	117
Television consistency Index	TLCI	60

Fixture settings: DMX mode: 1; Flower effect Off; White Point 8000K On; All pixels On
Measurement date: 09.06.2020

Spider®



Packaging

Cardboard - 485 x 390 x 555 mm

Single Top Loader Case - 486 x 442 x 600 mm

Dual Top Loader Case - 620 x 600 x 710 mm

Quad Top Loader Case - 1200 x 600 x 710 mm

 **ROBIN**[®]
Innovative Technology

www.robe.cz

ROBE[®]

Head office: ROBE lighting s. r. o. | Hážovice 2090 | 756 61 Rožnov pod Radhoštěm | Czech Republic

Factory: ROBE lighting s. r. o. | Palackého 416 | 757 01 Valašské Meziříčí | Czech Republic

Tel.: +420 571 751 500 | E-mail: robe@robe.cz

July 2025 © ROBE lighting s. r. o. All specifications subject to change without notice.